

Restoration and **prosthetics**

#whdentalwerk
f @ in ▶
video.wh.com

Now at your
dealer or
wh.com



Restoration and **prosthetics**

COMPANY	4–5
Product overview 1 for Primea Advanced Air, Synea Vision, Synea Fusion	6–7
Product overview 2 for Alegra, air motor, electric motor	8–9
Primea Advanced Air	10–11
Synea Vision turbine handpieces	12–15
Synea Vision straight and contra-angle handpieces	16–17
Synea Fusion turbine handpieces	18–19
Synea Fusion straight and contra-angle handpieces	20–21
Alegra turbine handpieces	22–23
Alegra straight and contra-angle handpieces	24–25
Alegra LED contra-angle handpieces with generator	26–27
Couplings	28–29
Air motor	30–31
Electric motor	32–33
Hygiene and maintenance	34–35
Technical data	36–44

People have Priority

W&H at a glance

- › Headquarters in Austria
- › 1,200 employees worldwide
- › Established in 1890 in Berlin by Jean Weber and Hugo Hampel
- › Production facilities in Austria, Italy and Sweden
- › Represented in 110 countries
- › Export share over 95%

For further information, head to wh.com



W&H Dentalwerk
Bürmoos (A)



W&H Sterilization
Brusaporto (I)



The stakes are high.
We are working with
people.

Our most important tool is experience: The company has been manufacturing high-quality straight and contra-angle handpieces since 1890. Constant innovation ensures a high level of quality in the field of restoration and prosthetics.

The secret of our success: W&H has kept the people at its heart – whether it be its partners, customers, patients or colleagues. It would only be human to ask whether this is actually the lived experience. Our suggestion: Put us to the test!

All the **advantages**
at a glance



“We have
tamed the air”



Primea Advanced Air

- › Controlled and efficient preparation thanks to automated speed control
- › Versatile and easy to use thanks to the adjustable bur speed of 60,000 to 320,000 rpm
- › Shadowless illumination of the treatment site for optimal visibility thanks to its 5x ring LED+ (RK-97 L)
- › Ergonomic and comfortable handling thanks to its low weight
- › Long lifespan and quiet operation thanks to ceramic ball bearings
- › Particularly stable in value and robust thanks to its scratch-resistant surface coating

[More information from page 10 onwards](#)

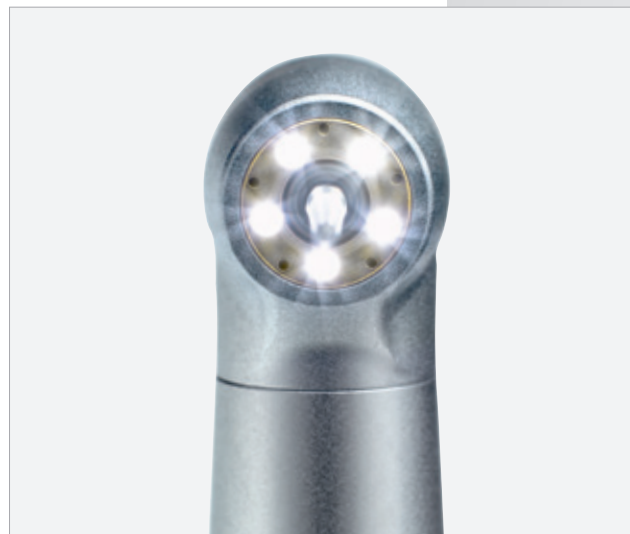

“A step ahead
of the future”



Synea Vision

- › Ring LED+ for shadow-free illumination
- › Scratch-resistant surface
- › Extremely powerful
- › Quiet operation
- › Long lifespan
- › With Roto Quick and Multiflex® connection
- › Hygienic head
- › Ceramic ball bearings
- › Perfect ergonomics
- › Various head sizes with 5x spray
- › Thermo washer disinfectable and sterilizable

[More information from page 12 onwards](#)



“The new definition
of price and power”



Synea Fusion

- › LED+ lighting
- › Small heads
- › Optimal solution
- › Light and quiet
- › Long lifespan
- › Available with Roto Quick and Multiflex® connection
- › Hygienic head
- › Ceramic ball bearings
- › Maximum efficiency during use
- › User comfort without compromise
- › Thermo washer disinfectable and sterilizable

[More information from page 18 onwards](#)



All the **advantages**
at a glance



“The perfect partner
when treating your
patients.”

Alegra

- › Fast and precise preparation
- › Exceptional ergonomics
- › Perfectly balanced
- › Robust and long-lasting
- › Changeable water filter
- › Precise cooling
- › Easy to change burs
- › Hygienic head
- › Optimal visibility
- › Thermo washer disinfectable and sterilizable

[More information from page 22 onwards](#)



“Powerful air
motors and
a long lifespan”

Air motor

- › Short and lightweight
- › The LED in the air motor ensures the best visibility
- › Powerful due to high torque
- › Long service life

[More information from page 30 onwards](#)



“Perfect balance
of power and
ergonomics”

Electric motor

- › Ergonomic, small and lightweight
- › Consistently high motor power
- › Improved visibility thanks to LED technology
- › Low noise and vibration
- › Maintenance-free and stable in value

[More information from page 32 onwards](#)



High speed under control

Primea Advanced Air helps you harness the air. As the world's first air-driven, high-speed drive solution with adjustable bur speed and constant tooth structure removal rate, even with increasing contact pressure, Primea Advanced Air gives you an optimal application speed and maximum treatment efficiency throughout operation, offering a unique symbiosis of strength and effortless for increased control with maximum comfort.



State prize winner 2018
State Prize for Innovation
from the Austrian Federal
Ministry for Digital and
Economic Affairs

Primea Advanced Air

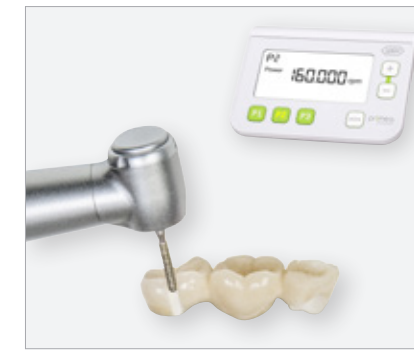

Separate crowns and bridges faster

Primea Advanced Air allows you to set the recommended speed for specific instruments and enjoy an optimal, constant tooth structure removal rate.



Effortlessly prepare cavities and crown stumps

By maintaining a high bur speed of 320,000 rpm, high-speed applications can be carried out efficiently and precisely.

Controlled finishing

Primea Advanced Air allows you to carry out this sensitive work step with a constantly low bur speed of just 60,000 rpm.



a Speed setting: Use the display to set the desired / recommended bur speed for the particular application.

b Speed comparison: The actual speed measured at the bur head is compared with the set speed.

c Speed regulation: If the actual speed deviates from the set value, the air supply is immediately adjusted accordingly.

Turbine handpieces for top-level requirements

Innovative. Flexible. Long service life.

High-end technology for excellent preparation results: Both Synea turbine handpiece equipment lines are characterized by their strong performance, optimal ergonomics and ideal price-performance ratio. Synea Vision stands for innovations such as the sterilizable 5x ring LED+ and Synea Fusion promises top quality with maximum economy.



Synea Vision Turbine handpieces



Ergonomic, light and quiet
Relaxed, fatigue-free working with a noticeably lighter turbine system.



Extraordinary value retention
Like new every day with the special, scratch-resistant surface coating.



Patented hygienic head system
The circulating air in the turbine head ensures no aerosol particles are sucked into the turbine as the rotor runs down.

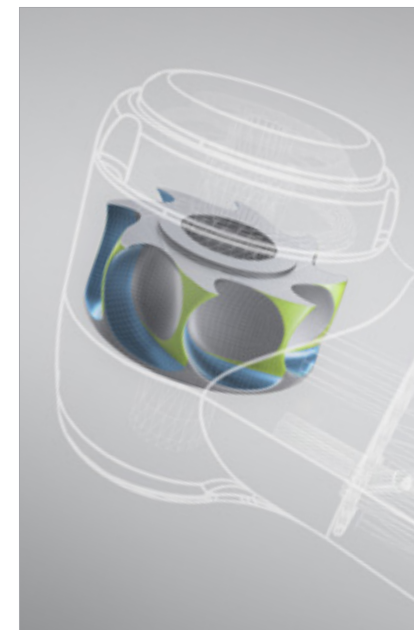

Full power ahead with the Power Blade Rotor
Higher rotor efficiency is achieved thanks to the optimized blade geometry. For maximum drive power and an optimal tooth structure removal rate throughout the entire preparation.



Customized turbine handpieces
The correct head size for every application for optimal access to the treatment site.

Ring LED+ and micro turbine TK-94 L

Innovative. Versatile. Long service life.

The world's first sterilizable turbine handpieces with 5x ring LED+ not only score highly due to their shadowless illumination, but are also distinguished as first-class quality turbines in all respects. Experience a completely new working sensation – without any shady sides. With its extra small head, the TK-94 L is perfect for minimally invasive procedures and provides the best access to the treatment site.



Synea Vision Turbine handpieces

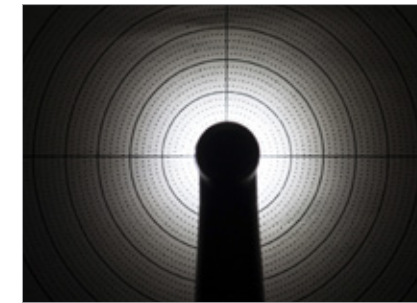

Synea Vision Ring LED+
Shadowless illumination of the treatment site with the unique 5x ring LED+.

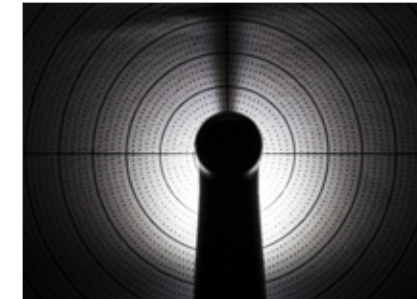

In comparison with Synea Fusion
with an LED+.



Improved visibility
Optimal contrast and natural illumination with maximum colour rendering with LED+.



Small head with many benefits
With a head diameter of just 9 mm and a total head height of 17.2 mm with mounted 16 mm bur...



... patients with a restricted mouth opening as well as children and the elderly will see the biggest benefits.

Ultimate technology

Precision. Elegance. Comfort.

A range for all applications: With the new Synea Vision equipment line, W&H has developed a range of top-quality transmission instruments. Two high-speed head sizes provide surprising access options. And a special coating for even greater aesthetics, and a longer service life.



Synea Vision Straight and contra-angle handpieces

synea VISION

For the future

- › Perfect ergonomics and quiet operation
- › Long lifespan
- › Versatile range
- › Value retention due to special coating



Small heads

Two high-speed head sizes and the world's smallest head height for low-speed motors. Ideal even for patients with a restricted mouth opening.



Synea Vision Short Edition

The new Synea Vision Short Edition significantly simplifies the treatment process due to its reduced weight and length.



5x spray

The 5x spray ensures uniform cooling of the treatment site, under any conditions.



Perfectly balanced

The Short Edition contra-angle handpieces sit perfectly in your hand.

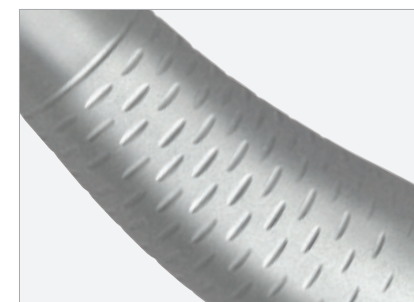

Scratch-resistant surface

even with the small Synea Vision contra-angle handpieces.

The new force in price and power

Economical. Long service life. Ergonomic.

Uncompromising user comfort and maximum performance combined with exceptional economy: Discover the advantages of the new Synea Fusion equipment line.



Synea Fusion Turbine handpieces

Made in
AUSTRIA



Reliability

Top quality and a long lifespan.



LED+ experience

Excellent illumination with natural colour rendering and optimal positioning of the LED.



Optimum cooling of four sides

Constant cooling and optimal cleaning of the treatment site thanks to 4x spray.



You have the choice

Choose between two different head sizes and decide on the connection that best suits your coupling system.

The W&H Roto Quick offers you unbeatable LED+ light and convenient 360° rotation.

Ultimate price-performance ratio

Economical. Ergonomic. Efficient.
Proven Synea quality has never been so affordable: With the Synea Fusion equipment line, W&H has developed a range of transmission instruments for which economy is valued just as highly as quality.



Synea Fusion Straight and contra-angle handpieces



Quality that pays off

- › Proven Synea quality
- › Maximum efficiency during use
- › User comfort without compromise



Good illumination
Compact glass rod for good illumination of the treatment site.



Small head
Best visibility and optimal access to the treatment site thanks to new small head sizes.

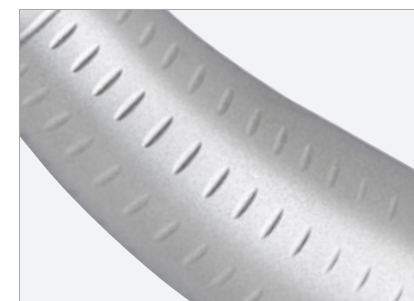

Optimized grip profile
for a secure hold and optimal hygiene.



Reciprocating contra-angle handpieces
Special reciprocating contra-angle handpieces for hard-to-reach areas.

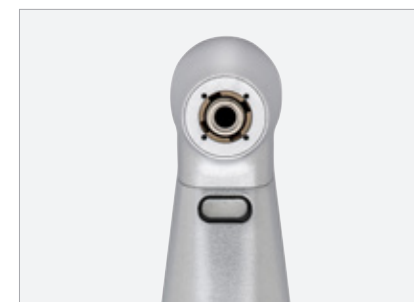

Optimum cooling of four sides
Constant cooling with the Quattro spray.

Long service life
and extremely quiet operation

Reliable. Efficient. Precise.
The Alegra turbine handpiece range offers high-end technology for the best preparation results! Experience maximum efficiency during use combined with the highest levels of safety: For you and your patients.

Alegra Turbine handpieces



LED turbine handpiece + quick coupling with generator = independent light

With the help of a generator in the Roto Quick coupling, light turbines can be used on the turbine hose without a power supply.



Precise cooling

The triple spray cools the treatment site from all sides and ensures safety during treatment.



Customized turbine handpieces

From hard-to-reach places to high tooth structure removal rates, we have the right head size for all applications.



Optimal visibility

The position of the LED on the turbine handpiece head ensures the best visibility and illumination of the treatment site.



Changeable water filter

Prevents the penetration of dirt particles into the turbine handpiece.

Highest level of application efficiency and safety during handling

Long service life. Compact. Precise.

With Alegra, you can treat your patient with the utmost efficiency and safety. Straight and contra-angle handpieces "Made in Austria" and developed in line with proven W&H quality.



Alegra straight and contra-angle handpieces

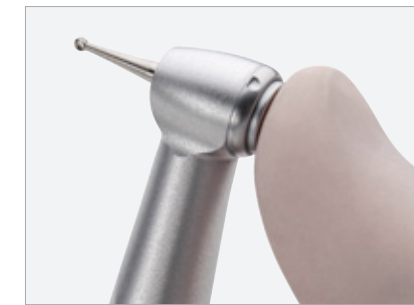

Easy to change burs

The push-button chucking system allows the bur to be changed quickly and easily.



Best visibility

The small contra-angle head ensures an unrestricted view of the treatment site,

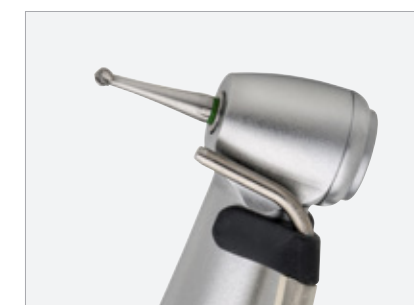

External spray cooling

The optionally available external spray clip ensures the treatment site is cooled.



Robust and long-lasting

High-quality materials make the Alegra straight and contra-angle handpieces particularly robust and long-lasting.



Cost-effective Alegra sets

- › High-speed set 4 RM (REF 90000132): TE-95 RM, WE-56, AM-25 RM
- › High-speed set 5 RM (REF 90000133): TE-95 RM, WE-56

Daylight quality LED+ for all

Drive on = LED+ on.

An in-built generator acts as the integrated energy source for LEDs, according to the same principle as a bicycle dynamo. In this way, Alegra LED+ contra-angle handpieces offer you natural daylight quality, regardless of whether the drive has its own light.



Alegra LED Contra-angle handpieces with generator



Guaranteed reliability

Contra-angle handpieces made in Austria: long-lasting, enduring and precise.



High colour rendering index (CRI)

The secret is in the contrast: the Alegra CRI of over 90 delivers a natural reproduction of red tones and strong colour contrast.



Working is more enjoyable with an LED+

Daylight quality light in the mouth: Thanks to the LED generator and optimal position of the light outlet.



Astonishingly innovative

The LED generator as the integrated energy source for LEDs, according to the same principle as a bicycle dynamo.

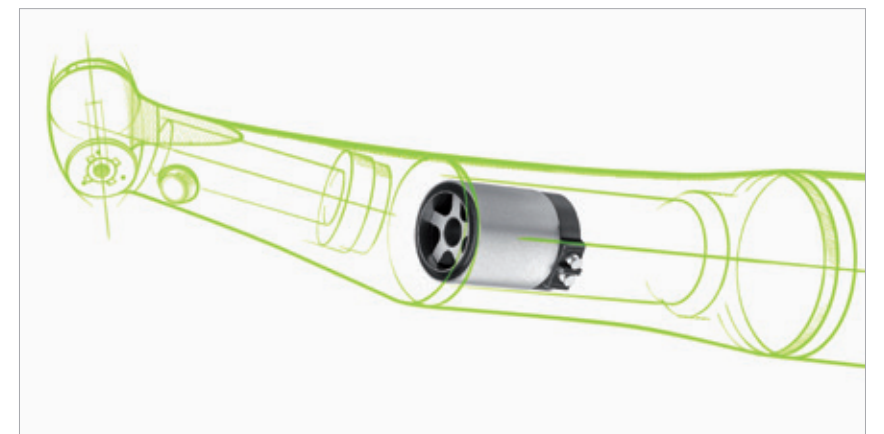

Absolutely independent

Daylight quality regardless of your unit and with no need for additional investment thanks to the built-in LED generator.

Versatile system interfaces

Lightweight. Flexible. Sterilizable.
Roto Quick couplings are versatile and suitable for use with turbine handpieces with ring LED+, LED+, LED and halogen light. They can be used for all standardized turbine hoses.



Couplings



Highest level of compatibility
Compatible with all turbine handpieces, air motors and scalers with Roto Quick and Multiflex®* connections.



360° rotation of the transmission instruments
Ease of handling, prevents the hose from becoming twisted.



Continuously variable spray water supply
Individual adjustments can be made quickly by the user, even during treatment.



Non-retraction valve
Reduces the contaminated spray water flowing back in, thus minimizing the risk of infection.



Couplings with generator
With the help of a generator in the Roto Quick coupling, light turbines can be used on the turbine hose without a power supply.



Coupling for Multiflex® connection
Coupling with LED can be used in addition to the conventional halogen couplings without making the slightest changes to the dental unit.

* Multiflex® is a trademark of a third party not affiliated with W&H Dentalwerk Bürmoos GmbH.

High motor power and long lifespan

Compact. Lightweight. LED.

The air motors are characterized by their high motor power and long lifespan. Their performance can be controlled smoothly in both forward and reverse operation. They work quietly and are comfortably lightweight. Air motors are available with or without light.



Air motor

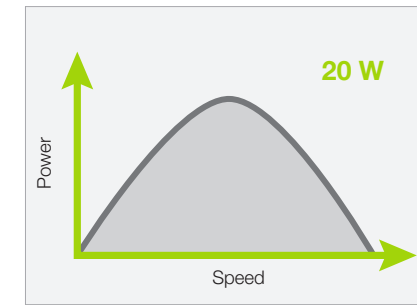

High drive power

The powerful air motors allow you to use the straight and contra-angle handpieces efficiently.



LED light

The LED in the AM-25 L RM air motor ensures optimal visibility and illumination of the treatment site.



Exceptional ergonomics

Straightforward 360° rotation of the contra-angle handpiece on the air motor, low overall weight and a slim design enable fatigue-free working.



AM-25 L RM, AM-25 A BC/RM, AM-25 E BC/RM, AM-25 BC/RM, AM-25 LT, AM-25 A, AM-25, AM-25 E, AM-25 RQ, AM-20 RQ

W&H offers an optimal range of air motors suitable for your straight and contra-angle handpieces. Air motors are available with the Borden 2(3)-hole system, standard 4-hole system and standard 6-hole system and with the Roto Quick connection.

Variety of applications with electric power

Powerful. Versatile. Small.

The brushless electric motor sits perfectly in your hand and scores points due to its high motor power and LED technology. The sensor-controlled drive technology ensures precise speeds over the entire speed range. For the best treatment results.



Electric motor



Particularly small

The comparison shows: The EM-12 L is no larger than a matchbox.



Improved visibility with LED light

The LED technology integrated in the motor enables the treatment site to be illuminated as bright as day.



Add-on

If you use the add-on as a tabletop device, the sterilizable tray offers an additional storage area.



Built-in solution

Selected unit manufacturers offer the W&H EM-12 L electric motor as a fully integrated drive solution as part of the overall system. Operation is simple and convenient via the control panel of your dental unit. Ask W&H or your unit manufacturer about the EM-12 L as a built-in solution.

Advanced Infection prevention Management Solutions

W&H AIMS provides a **step-by-step hygiene and reprocessing workflow** to interrupt the chain of infection and prolong the lifespan of instruments.



Complete product range as a holistic solution

W&H offers a wide range of products for safe reprocessing of instruments, handpieces, contra-angle handpieces and turbine handpieces following the recommended W&H AIMS hygiene workflow.



Primea Advanced Air Turbine handpieces



Type:	RK-97 L	RG-97 L
Speed range as Advanced Air turbine handpiece:	60,000–320,000 rpm	
Maximum power as Advanced Air Turbine (add-on):	27 W ± 10% at 6–8 bar input pressure	
Maximum power as Advanced Air Turbine (built-in):	30 W ± 10% at 5.5–5.9 bar input pressure	
Speed range as standard turbine handpiece:	400,000 rpm	
Maximum power as standard turbine handpiece:	21 W at 3 bar input pressure	
Head with bur:	Ø 10 mm	
Head height with bur (19 mm):	21.1 mm	
Weight:	39 g	
Volume:	57 dB(A)	
Rotary instruments:	FG bur Ø 1.6 mm, in accordance with ISO 1797	
Maximum working part diameter:	2 mm	
Maximum length:	21 mm	
Coupling:	Roto Quick	
Light:	Ring LED+	LED+
Light intensity:	25,000 lux	
Spray:	5x	
Ball bearings:	Ceramic	
Warranty:	24 months	12 months

Synea Vision Turbine handpieces



Types with integral ceramic ball bearings:	TK-94 L / TK-94 LM	TK-97 L / TK-97 LM	TK-98 L / TK-98 LM	TK-100 L / TK-100 LM
Light:	LED+ / compact glass rod	Ring LED+ / compact glass rod	Ring LED+ / compact glass rod	Ring LED+ / compact glass rod
CRI (LED version):	> 90	> 90	> 90	> 90
Colour temperature (LED version):	5,500 K	5,500 K	5,500 K	5,500 K
Luminous flux (lumen):	6.0 / 4.0**	6.0 / 4.0**	6.0 / 4.0**	6.0 / 4.0**
Light intensity:	25,000 lux	25,000 lux	25,000 lux	25,000 lux
Coupling:	1 Roto Quick 2 Multiflex®***	1 Roto Quick 2 Multiflex®***	1 Roto Quick 2 Multiflex®***	1 Roto Quick 2 Multiflex®***
Head size:	Ø 9 mm	Ø 10 mm	Ø 11.5 mm	Ø 13 mm
Head height:	17.2 mm (with bur 16 mm)	21.1 mm (with bur 19 mm)	21.4 mm (with bur 19 mm)	21.4 mm (with bur 19 mm)
Power*:	14 W	21 W	24 W	26 W
Speed (rpm):	410,000	400,000	360,000	330,000
Rotary instruments:	FG bur, in accordance with ISO 1797, with Ø 1.6 mm			
Max. working part diameter:	1.5 mm	2 mm	2 mm	2.5 mm
Max. length:	16 mm	21 mm	25 mm	25 mm
Weight:	39 g / 67 g	38 g / 68 g	40 g / 69 g	40 g / 70 g
Operating pressure: Roto Quick connection:	3 ± 0.3 bar	3 ± 0.3 bar	3 ± 0.3 bar	3 ± 0.3 bar
Operating pressure: Multiflex® connection:	2.5 to 4 bar	2.5 to 4 bar	2.5 to 4 bar	2.5 to 4 bar
Spray:	5x	5x	5x	5x
Volume:	59 dB(A)	57 dB(A)	57 dB(A)	57 dB(A)

* Performance value applies at nominal operating pressure of 3 bar and return air pressure of maximum 0.2 bar

** Values apply when using RM-34 LED with DC power supply

*** Multiflex® is a trademark of a third party not affiliated with W&H Dentalwerk Bürmoos GmbH

Primea Advanced Air Add-on

Type:	AF-100
Speed range:	60,000–320,000 rpm
Modes:	Power / tactile
Supply voltage:	100–240 V
Dimensions (height x width x depth):	92 x 156 x 211 mm
Weight:	1.33 kg
Warranty:	24 months
Input pressure of the air connection hose:	600–800 kPa (6–8 bar, 87–116 psi)
Air consumption:	maximum 65 l/min

Suitable accessories (optional)

- › Holders: Fastening options for flexible assembly and individual positioning.
- › Tray: Practical, disinfected and sterilizable storage for your instruments.

Synea Vision

Straight and contra-angle handpieces



Types with light (compact glass rod)	WK-99 LT WK-99 LT S	WK-93 LT WK-93 LT S	WK-66 LT WK-66 LT S	WK-56 LT WK-56 LT S	WK-86 LT	HK-43 LT
Head size:	Ø 9.5 mm	Ø 9.1 mm	Ø 9.5 mm	Ø 9.5 mm	Ø 9.5 mm	–
Head height with bur (19 mm):	21.6 mm	21.2 mm	20 mm	20 mm	20 mm	–
Rotary instruments:	FG bur	FG bur	Contra-angle handpiece bur	Contra-angle handpiece bur	Contra-angle handpiece bur	Straight and contra-angle handpiece bur
Max. working part diameter:	Ø 2.5	Ø 2	–	–	–	–
Max. length:	25 mm	21 mm	34 mm	34 mm	34 mm	34 mm
Transmission/reduction ratio:	1:5	1:4.5	2:1	1:1	8:1	1:1
Spray:	5x (> 50 ml/min)	5x (> 50 ml/min)	1x (> 50 ml/min)	1x (> 50 ml/min)	1x (> 50 ml/min)	1x (> 50 ml/min)
Light intensity for types with light:	25,000 lux	25,000 lux	25,000 lux	25,000 lux	25,000 lux	25,000 lux
Areas of application:	<ul style="list-style-type: none"> Preparation of crown stumps and cavities Dental trepanning Resectioning Finishing Removal of fillings and metals 	<ul style="list-style-type: none"> Preparation of crown stumps and cavities Dental trepanning Resectioning Finishing Removal of fillings and metals 	<ul style="list-style-type: none"> Excavating Preparations close to the pulp Finishing 	<ul style="list-style-type: none"> Preparation of cavities Dental trepanning Resectioning Separating Finishing of cavity margins and fillings 	<ul style="list-style-type: none"> Excavating Preparations close to the pulp Root canal filling Cementing 	<ul style="list-style-type: none"> Preparing Separating Dental trepanning Resections in the anterior region Basic technical procedures

	ISO standard WK-93 LT + EM-E8 LED + VE-9	ISO short WK-93 LTS + EM-12 L + VE-10
Length (to the end of the hose coupling):	189 mm	160 mm
Weight:	198 g	150 g

Synea Fusion

Turbine handpieces



Types:	TG-97 L / TG-97 L RM / TG-97 LM / TG-97 LN / TG-97	TG-98 L / TG-98 L RM / TG-98 LM / TG-98 LN / TG-98
Light:	LED+ / LED+ compact glass rod / compact glass rod / –	LED+ / LED+ compact glass rod / compact glass rod / –
CRI (LED version):	> 90	> 90
Colour temperature (LED version):	5,500 K	5,500 K
Luminous flux (lumen):	6.0 / 6.0 / 4.0** / depending on coupling / –	6.0 / 6.0 / 4.0** / depending on coupling / –
Light intensity:	25,000 lux	25,000 lux
Coupling:	<ul style="list-style-type: none"> 1 Roto Quick RM connection 2 Multiflex®*** NSK Mach®*** 	<ul style="list-style-type: none"> 1 Roto Quick RM connection 2 Multiflex®*** NSK Mach®***
Head size:	Ø 10 mm	Ø 11.5 mm
Head height:	21.1 mm (with bur 19 mm)	21.4 mm (with bur 19 mm)
Power*:	18 W	21 W
Speed (rpm):	390,000	360,000
Rotary instruments:	FG bur, in accordance with ISO 1797, with Ø 1.6 mm	
Max. working part diameter:	2 mm	2 mm
Max. length:	21 mm	25 mm
Weight:	40 g / 43 g / 68 g / 52 g / 40 g	42 g / 44 g / 70 g / 53 g / 42 g
Operating pressure: Roto Quick connection:	3 ± 0.3 bar	3 ± 0.3 bar
Operating pressure: Multiflex® connection:	2.5 to 4 bar	2.5 to 4 bar
Spray:	4x	4x
Volume:	59 dB(A)	59 dB(A)

* Performance value applies at nominal operating pressure of 3 bar and return air pressure of maximum 0.2 bar

** Values apply when using RM-34 LED with DC power supply

*** Multiflex® and NSK® are trademarks of third parties not affiliated with W&H Dentalwerk Bürmoos GmbH

Synea Fusion

Straight and contra-angle handpieces



Types with light (compact glass rod)	WG-99 LT	WG-66 LT	WG-56 LT		WG-67 LT
Types without light	WG-99 A	WG-66 A	WG-56 A	HG-43 A	WG-67 A
Head size:	Ø 9.5 mm	Ø 9.5 mm	Ø 9.5 mm	–	–
Head height with bur (19 mm):	21.6 mm	20 mm	20 mm	–	–
Rotary instruments:	FG bur	Contra-angle handpiece bur	Contra-angle handpiece bur	Straight and contra-angle handpiece bur	Stroke 1.1 for Dentatus tips
Max. working part diameter:	Ø 2.5	–	–	–	Specified by the available files / tips
Max. length:	25 mm	34 mm	34 mm	34 mm	
Transmission/reduction ratio:	1:5	2:1	1:1	1:1	2:1
Spray:	4x (> 50 ml/min)	1x (> 50 ml/min)	1x (> 50 ml/min)	1x (> 50 ml/min)	1x (> 50 ml/min)
Light intensity for types with light:	25,000 lux	25,000 lux	25,000 lux	–	25,000 lux
Areas of application:	<ul style="list-style-type: none"> › Preparation of crown stumps and cavities › Dental trepanning › Resectioning › Finishing › Removal of fillings and metals 	<ul style="list-style-type: none"> › Excavating › Preparations close to the pulp › Finishing 	<ul style="list-style-type: none"> › Preparation of cavities › Dental trepanning › Resectioning › Separating › Finishing of cavity margins and fillings 	<ul style="list-style-type: none"> › Preparing › Separating › Dental trepanning › Resections in the anterior region › Basic technical procedures 	<ul style="list-style-type: none"> › Removal of excesses › Prepolishing › Fine polishing › Polishing in the interdental and subgingival area › Speed max. 20,000 rpm

Alegra

Turbine handpieces



Turbine handpieces with LED Couplings with generator Turbine handpieces without light	TE-97 LQ* RQ-53 / RQ-54 TE-97 / TE-97 RM / TE-97 BC	TE-98 LQ* RQ-53 / RQ-54 TE-98 / TE-98 RM / TE-98 BC	TE-95 RM / TE-95 BC
Light (LED version):	LED and generator	LED and generator	–
Light intensity (LED version):	25,000 lux	25,000 lux	–
Head size:	Ø 10.4 mm	Ø 12.2 mm	Ø 12.2 mm
Power**:	16 W	18 W	18 W
Speed:	390,000 rpm	330,000 rpm	330,000 rpm
Rotary instruments:	FG bur, in accordance with ISO 1797-1, with Ø 1.6 mm		
Maximum working part diameter:	2 mm	2 mm	2 mm
Maximum length:	21 mm	25 mm	25 mm
Weight:			
› Turbine handpieces with LED	46 g	48 g	
› Couplings with generator	26 g / 20 g	26 g / 20 g	
› Turbine handpieces without light	46 g / 47 g / 47 g	48 g / 50 g / 50 g	49 g / 49 g
Operating pressure:	2.2–2.8 bar (32–40 psi)		
Ball bearings:	Ceramic	Ceramic	Steel
Spray:	3x	3x	1x
Volume:	62 dB(A)		

* TE-97 LQ and TE-98 LQ turbine handpieces with LEDs are only intended for use with W&H RQ-53 and RQ-54 Roto Quick couplings.

** Performance value applies at nominal operating pressure for turbine handpieces without light of 2.5 bar, for turbine handpieces with light of 2.8 bar and return air pressure of maximum 0.2 bar.

In operation with a maximum permissible operating pressure of 2.8 bar, it is possible to reach 18 watts for TE-97, TE-97 RM, TE-97 BC, and 20 watts for TE-98, TE-98 RM, TE-98 BC.



Types with LED Types without light*	TE-97 C LED G TE-97 C	TE-98 C LED G TE-98 C	TE-95
Illumination quality:	LED+	LED+	–
CRI:	> 90	> 90	–
Colour temperature (K):	5,500	5,500	–
Luminous flux (lumen):	6.0	6.0	–
Brightness (lux):	25,000	25,000	–
Head size (Ø mm):	10.4	12.2	12.2
Power (W):	14	16	16
Speed (rpm):	390,000	330,000	330,000
Rotary instruments:	FG bur, in accordance with EN ISO 1797-1:1995		
Ø / max. length (mm):	1.6 / 21	1.6 / 25	1.6 / 25
Ball bearings:	Ceramic	Ceramic	Steel
Spray:	3x	3x	1x

Operating pressure 2.5–2.8 bar

Multiflex® and NSK® are trademarks of third parties not affiliated with W&H Dentalwerk Bürmoos GmbH.

* The turbine handpieces without light are exclusively available with the W&H Roto Quick®, Borden 2(3)-hole or standard 4-hole connection options.

Turbine handpieces with LED are compatible with

- › Borden 2(3)-hole
- › Standard 4-hole
- › W&H Roto Quick®
- › KaVo Multiflex®
- › NSK QD-J®

Alegra

Straight and contra-angle handpieces



Type:	WE-56	WE-57	WE-66	HE-43
Transmission ratio:	1:1	1:1	4:1	1:1
Head size:	Ø 10.1 mm	Ø 10.1 mm	Ø 10.1 mm	–
Head height (with bur 19 mm):	20.8 mm	22.7 mm	20.8 mm	–
Rotary instruments:	Contra-angle handpiece bur	FG bur	Contra-angle handpiece bur	Straight and contra-angle handpiece bur
Instrument shaft diameter:	2.35 mm	1.6 mm	2.35 mm	2.35 mm
Maximum length:	34 mm	25 mm	34 mm	50 / 34 mm
Weight:	65 g	65 g	65 g	72 g
Spray (optional):	1x external			



Types with LED+	WE-99 LED G	WE-56 LED G	WE-66 LED G
Illumination quality:	LED+	LED+	LED+
CRI:	> 90	> 90	> 90
Colour temperature (K):	5,500 K	5,500 K	5,500 K
Luminous flux (lumen):	5.0	5.0	5.0
Brightness (lux):	25,000	25,000	25,000
Transmission/reduction ratio:	1:4.5	1:1	4:1
Head size (Ø mm):	10.1	10.1	10.1
Head height (mm) 19 mm bur:	22.3	20.7	20.7
Rotary instruments:	FG bur	Contra-angle handpiece bur	Contra-angle handpiece bur
Instrument shaft diameter	1.6 mm	2.35 mm	2.35 mm
Maximum length:	25 mm	34 mm	34 mm
Spray:	3x	1x	1x
Warranty:	12 months		

ISO connection for electric motors and air motors

Couplings



Roto Quick couplings:	RQ-24	RQ-34	RQ-14	RQ-03	RQ-04	RQ-53	RQ-54
Light:	Yes	Yes	–	–	–	Generator	Generator
Spray regulator:	–	Yes	Yes	–	–	–	–
Connection:	6-hole	6-hole	Standard 4-hole	2(3)-hole	Standard 4-hole	2(3)-hole	Standard 4-hole



W&H coupling for Multiflex® connection:	RM-34 LED
Light:	LED
Spray regulator:	Yes
Connection:	6-hole

Light, flexible and sterilizable: W&H Roto Quick couplings are versatile and suitable for use with transmission instruments with LED+, LED and halogen light. 24-month warranty.

Coupling with LED can be used in addition to the conventional halogen couplings without making the slightest changes to the dental unit. Long lifespan – 24-month warranty.

* Multiflex® is a trademark of a third party not affiliated with W&H Dentalwerk Bürmoos GmbH.

Air motor



Type:	AM-25 L RM	AM-25 A RM / AM-25 E RM / AM-25 RM	AM-25 A BC / AM-25 E BC / AM-25 BC	AM-25 LT / AM-25 A / AM-25 E / AM-25 /	AM-25 RQ / AM-20 RQ
Hose-end coupling:	Fixed connection Standard 6-hole	Fixed connection Standard 4-hole	Fixed connection Borden 2(3)-hole	Roto Quick Connection	Roto Quick Connection
Light (LED version):	LED	–	–	Light / – / – / –	– / –
Spray:	intern	intern extern –	intern extern –	intern intern extern –	– –
Weight:	77 g	78 g / 75 g / 73 g	78 g / 74 g / 73 g	82 g / 80 g / 85 g / 85 g	71 g / 54 g
Max. Power:	up to 30 W				
Speed range (rpm) at an operating pressure of:	2,5 bar: 5.000 – 20.000* 3 bar: 5.000 – 25.000*				
Direction of rotation:	Forward/reverse operation				

* Performance and speed for air drives are dependent on the quality of the turbine hose used and may differ from the specified value.

Manufacturer:

W&H Dentalwerk Bürmoos GmbH

Ignaz-Glaser-Straße 53, Postfach 1

5111 Bürmoos, **Austria**

t +43 6274 6236-0

f +43 6274 6236-55

office@wh.com

wh.com